



**3605 Concord Ave | Schofield, WI**

**Total building:** 330,000 SF

**Total available:** Building 5 - 75,000 SF  
Building 7 - 106,250 SF

**Available:** Upon 30-day notice

**Year built:** Building 5 - 1988  
Building 7 - 1998

**Loading:** Building 5 - 6 Docks, 2 Drive-in  
Building 7 - 10 Docks, 2 Drive-in

**Clear Height:** Building 5 - 27'-2" Peak, 23' Eave  
Building 7 - 32'9" Peak, 27' Eave

**Power:** 400 amp, 3-phase

**Fire Protection:** CMDA Storage Application

**Zoning:** Limited Industrial

**Parcel number:** 119228081710969 &  
19228081710970

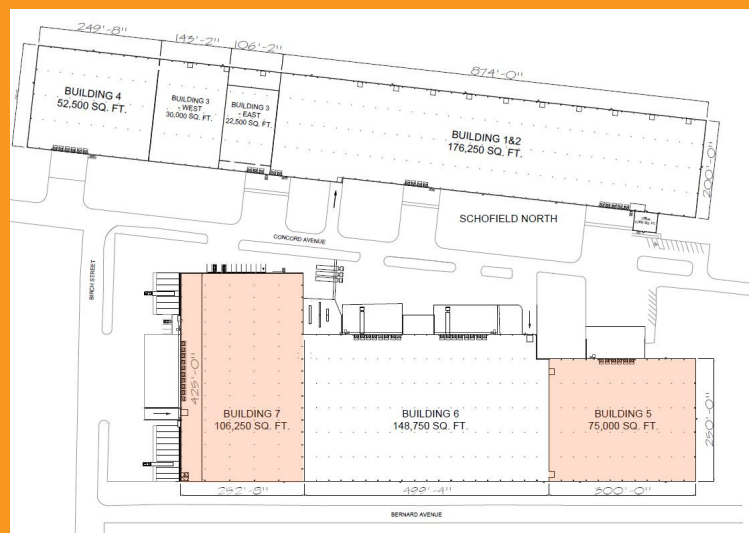

**Contact Us**

Jamie Sager | Manager of Real Estate and Leasing  
JamieSa@wowlogistics.com  
(920)415-3745

